

Capitol Theatre

VENUE INFO

ADDRESS: <u>405 Cleveland St</u> <u>Clearwater, FL 33755</u>	PROSCENIUM: <u>W 28'10" X H 12'</u> STAGE DEMINSIONS: <u>W 33'X D 22' X H 16'</u>	AUDIO PWR: <u>100AMP</u> OTHER PWR: <u>200AMP</u>
PHONE: <u>727-442-6152</u>	LINE-SETS: NO	HSE PA: <u>6 EAW KF650's (3 PER SIDE)</u> <u>2 EAW SB600 Subs (1 PER SIDE)</u>
FAX: <u>727-441-8388</u>	To grid from stage floor: <u>16'</u>	MIX POSITION: <u>54FT @ REAR OF HSE</u>
BOX OFFICE: <u>727-441-2975</u>	From stage floor to ceiling: <u>17'2"</u>	SNAKE RUN TO FOH: <u>120FT</u>
URL: <u>www.rutheckerdhall.com</u>	LOAD-IN: REAR OF BUILDING FROM ALLEY	SPOTS: <u>YES / 1</u>
CAPACITY: <u>475</u>	SHORE PWR: <u>NO</u>	
VENUE TYPE: <u>Procenium Theater</u>	DRESSING ROOMS: <u>YES / 2 (NO Showers)</u>	
SEATING: <u>Balcony/Orchestra</u>		
STAGE TYPE: <u>PINE (TONGUE & GROOVE)</u>		
FIRE CURTAIN: <u>NO</u>		

CONTACTS

PRODUCTION CONTACT:	PROMOTER/SETTLEMENT:	CATERING:
Megan Byrne / PRODUCTION MGR.	Bobby Rossi / ENTERTAINMENT DIR.	Mike Jeckel / F & B MANAGER
PHONE: <u>727-441-1155</u>	PHONE: <u>727-712-2709</u>	PHONE: <u>727-712-2759</u>
FAX: <u>727-441-8388</u>	FAX: <u>727-724-5309</u>	FAX: <u>727-724-5976</u>
mbyrne@rutheckerdhall.net	bobby@rutheckerdhall.net	mieckel@rutheckerdhall.net

HOTEL/TRANSPO:	PROMOTER/SETTLEMENT:	MERCHANDISE:
James Raulerson / VENUE MGR	Kevin Stone / ENTERTAINMENT MGR	Sandy Villasuso / HSE MGR.
PHONE: <u>727-442-6152</u>	PHONE: <u>727-724-5302</u>	PHONE: <u>727-7122707</u>
FAX: <u>727-441-8388</u>	FAX: <u>727-724-5309</u>	FAX:
jraulerson@rutheckerdhall.net	kstone@rutheckerdhall.net	svillasuso@rutheckerdhall.net

PRODUCTION OFFICE #	2ND Floor Dressing Room	SECURITY:
LINE 1: <u>727-441-2863</u>	LINE 1: <u>727-441-2943</u>	John Goldsboro / SECURITY MGR.
This is located 1ST floor BACKSTAGE		PHONE: <u>727-712-2755</u>
		JGoldsboro2@rutheckerdhall.net

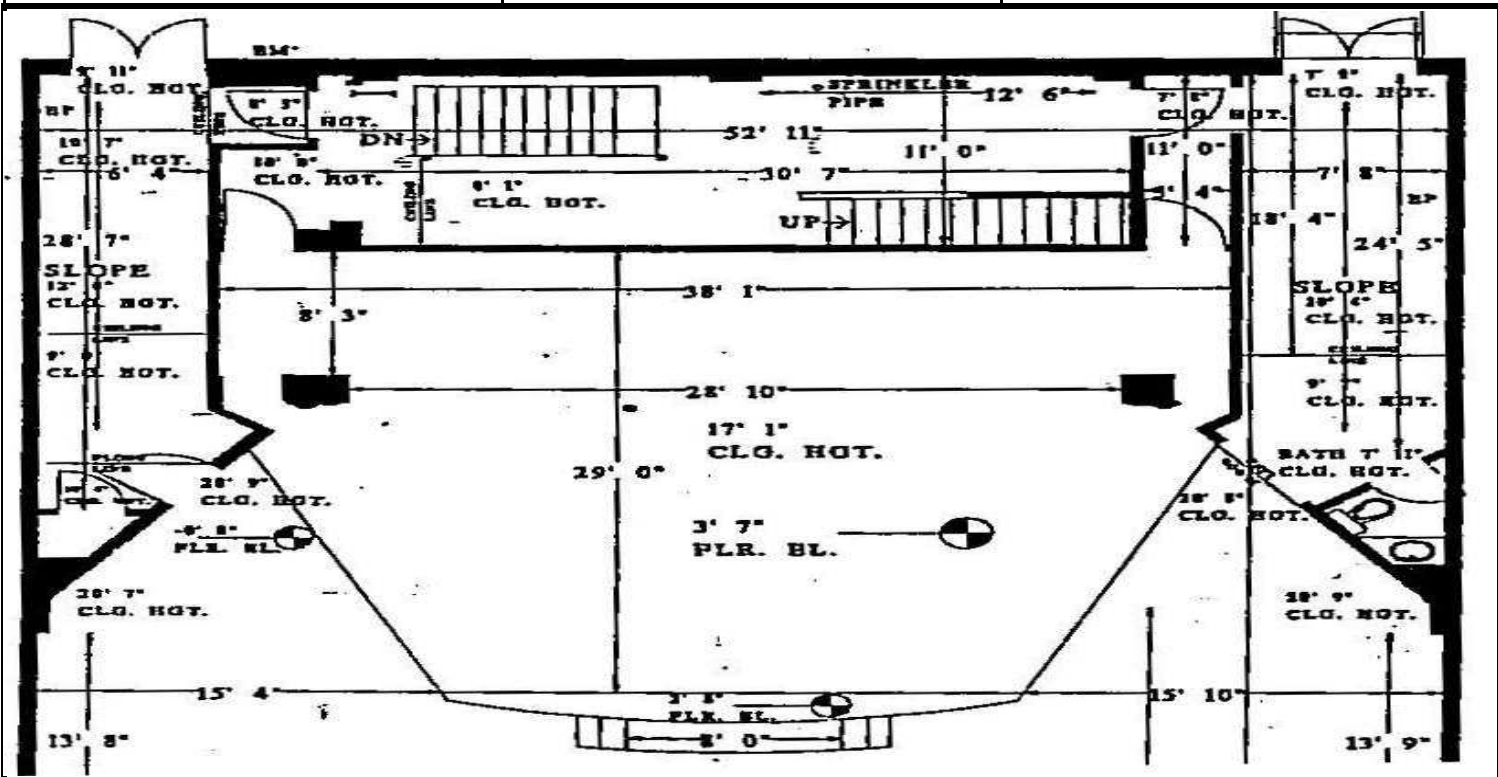

CAPITOL THEATRE

GENERAL TECHNICAL SPECIFICATIONS

2011

STAGE DIMENSIONS

DEPTH: 22' WIDTH: 33' upstage and then tapers down to 22' ½" to down stage edge.

HEIGHT: From stage floor to ceiling 17'2" From stage floor to bottom pipe 16'4"

Have hanging upstage 1-Red Curtain-W 33' x H 15'

SOUND

PA:

6-EAW650s 3-Per side w/ 2-EAW SB600 Subs 1-Per side

BSS OMNIDRIVE Processing

Crest Amplification

CONSOLE:

Allen & Heath Mix Wizard 16X2 Mixing Console

MONITORS:

2- JBL LRX112M 12X2

Crown Amplification

OUTBOARD / PROCESSING GEAR:

1-BSS FCS966 Dual 31-Band Graphic EQ

2- Ashley Dual-Channel Compressors (4-channels)

1-Yamaha Reverb

1-Tascam CD-A700 CD / Cassette Combo

MIC'S / STANDS / CABLES:

4-SHURE SM58's

2-SHURE SM57's

4-Radial Pro DI's

4-Tall Boom Stands

2-Short Boom Stands

4-Stright Round Base Stands

Assorted XLR & ¼ "Cables

LIGHTING

CONTROL:

Colortran Encore 48/96
NSI Dimming Rack

INSTRUMENTS:

34- Source 4 PAR
22- Source 4 LEKOS
09-FRESNELS 6"
06-ACL's
SPOT THROW 80'

PROJECTION:

EIKI EX-6000 16MM Sound Projector
EIKI IP-5000
Laptop, Switcher, DVD Player, VHS Player
Screen -15' X 20'

COMMUNICATION:

Technical Projects Intercom Base Station
6 Beltpacks/Headsets